



# Facades made from HPL boards

Facade HPL (High pressure laminate) boards belong to compact large-format material made of high-pressure decorative laminate. For its production is used laminated paper impregnated with resin and it is pressed under heat and high pressure into a homogeneous solid board.

The boards have excellent mechanical strength and resistance to weather conditions. It is a material with one of the best quality/ cost ratios for construction realization.

## 1) COLOR

Colors can be chosen from huge range of basic colors, wood and stone decors, metal and up to the abstract motifs.

## 2) FORMATS

Formats differ according to HPL manufacturers. They can be in sizes from 2440 x 1220 mm up to 4320 x 1660 mm. Thicknesses are also individual and standard thickness is 8 to 12 mm, but there is not an exception thickness 6 or 14 mm.

## 3) SURFACE

Surfaces can be polished, matt and in many other structures.

## 4) WAY OF FIXING AND DETAILS

- Invisible mechanical fixing
- Riveting
- Gluing

## 5) FLAMMABILITY

According to standard ČSN EN 13501-1 are HPL board standardly specify B in reaction to fire. But there are manufacturers who can be pride of products with reaction to fire A2 due to the improved technology.

*For more information contact Triangel company.*

Triangel spol. s r.o.  
Černokostecká 2085/24  
100 00 Praha 10  
Czech Republic

IČO: 65410777, DIČ: CZ65410777

+420 261 217 774  
trangel@triangel.cz  
WWW.TRIANGEL.CZ

**Complete supply  
of ventilated facades**

## Detail of window lintel

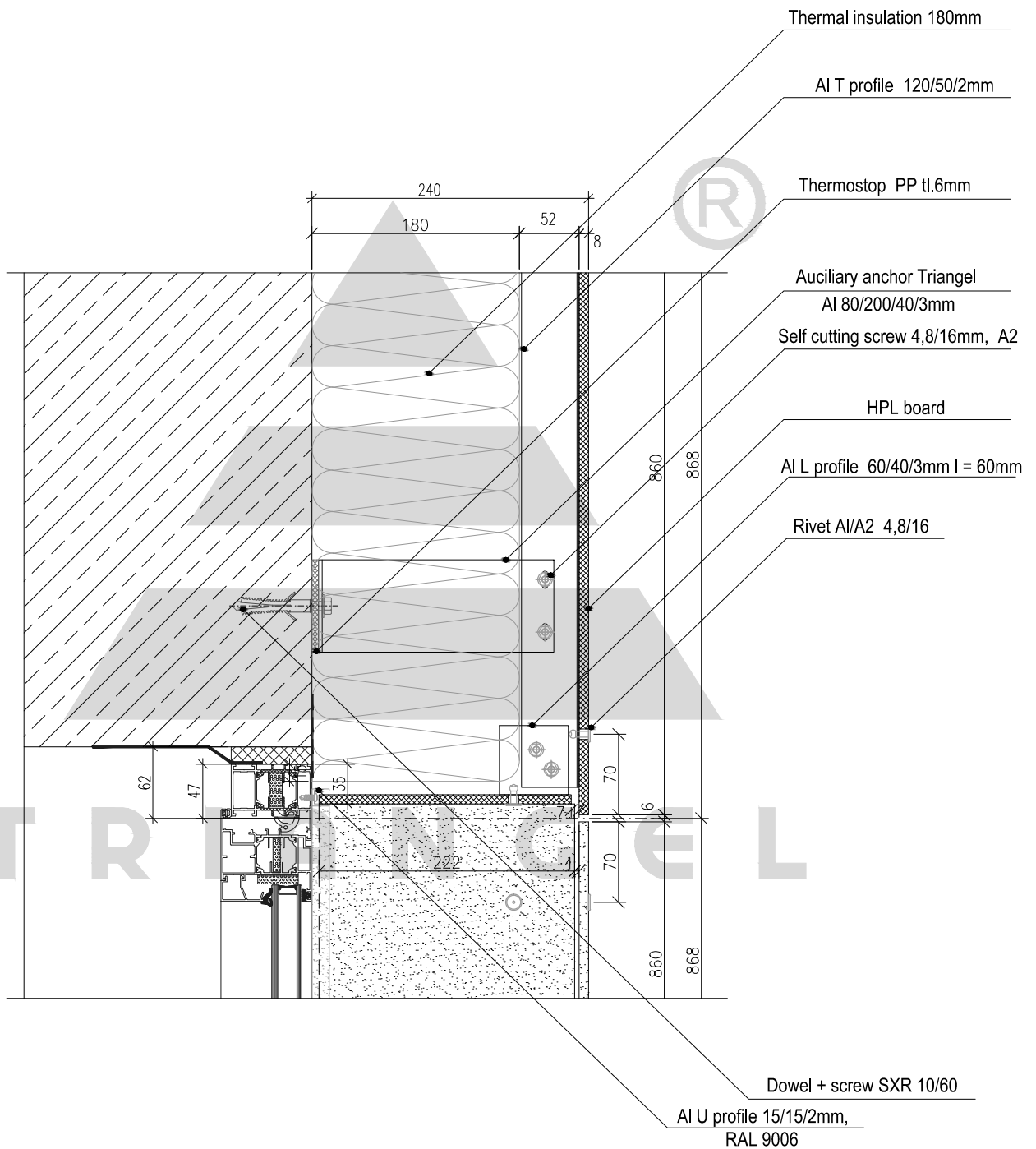

Triangel spol.s.r.o. keramika - přírodní kámen, kompletní dodávky fasád, dlažby, obklady  
Černokostelecká 2085/24, 100 00 Praha 10 www.triangel.cz tel/fax: +420 261 217 774

Vypracoval:

Měřítko:

1:5

Datum:

Název akce:

Název výkresu:

Výkr.č.

Visible fixing by riveting - HPL board  
Detail of window lintel

## Detail of window reveal

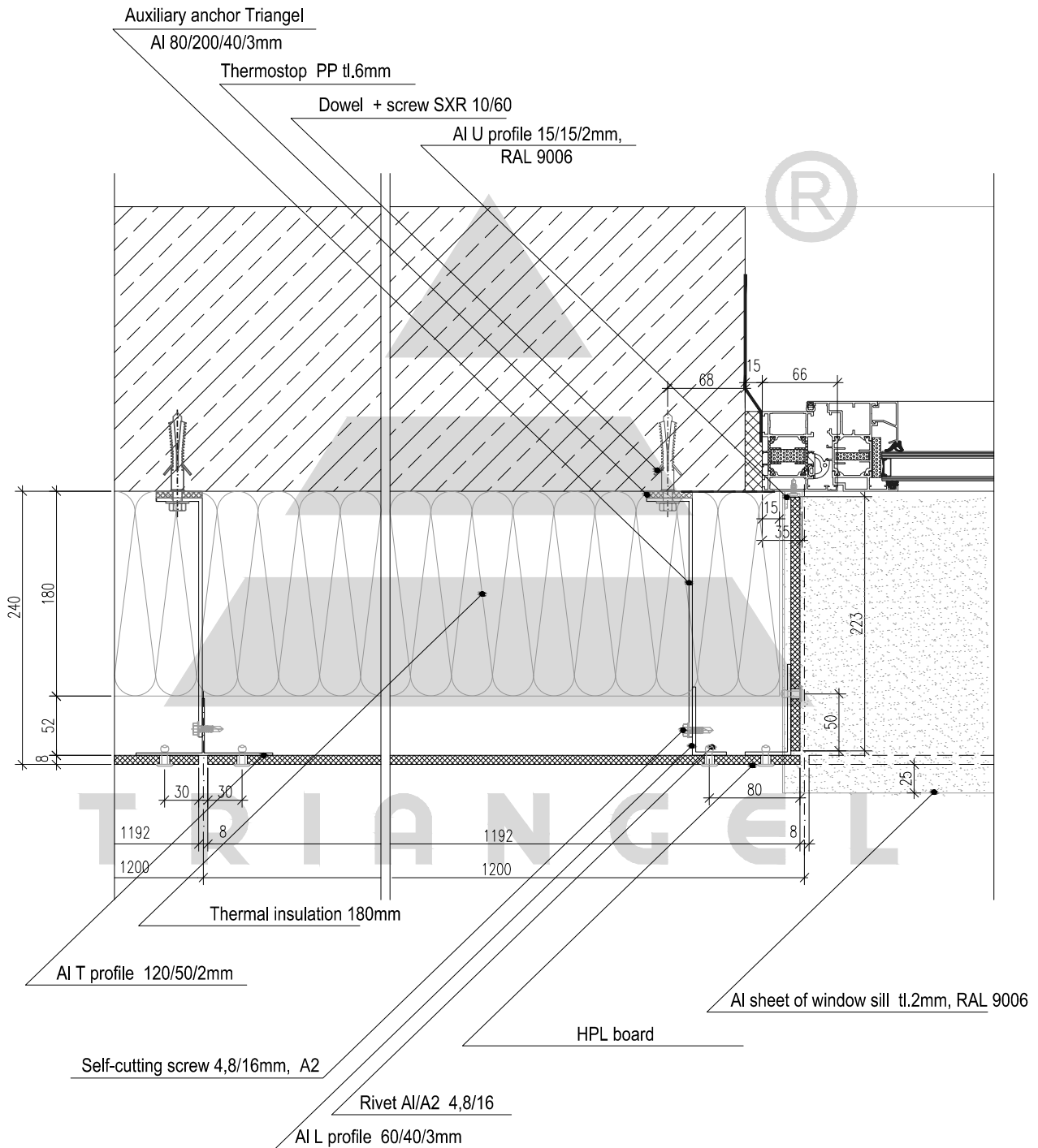

Triangel spol.s.r.o. keramika - přírodní kámen, kompletní dodávky fasád, dlažby, obklady  
Černokostelecká 2085/24, 100 00 Praha 10 www.triangel.cz tel/fax: +420 261 217 774

Vypracoval:

Měřítko:

1:5

Datum:

Název akce:

Název výkresu:

Výkr.č.

Visible fixing by riveting - HPL board  
Detail of window reveal

